

# **IMPORTANT PLEASE READ BEFORE USE**



### **SAFETY FIRST!**

Instructions Read the ENTIRE IMPORTANT SAFETY INFORMATION section at the beginning of this document including all text under subheadings therein before set up or use of this product.



### **SAFETY FIRST!**



### **SAFETY GLOVES**



### **EYE PROTECTION**



## **PLEASE READ THE FOLLOWING CAREFULLY**

THE MANUFACTURER AND/OR DISTRIBUTOR HAS PROVIDED THE PARTS LIST AND INSTALLATION PHOTOGRAPHY IN THIS DOCUMENT AS A REFERENCE TOOL ONLY.



### **SAFETY FIRST!**

**WARNINGS, CAUTIONS AND INSTRUCTIONS DISCUSSED IN THIS MANUAL CANNOT COVER ALL POSSIBLE CONDITIONS OR SITUATIONS THAT COULD OCCUR. It must be understood by the user that common sense and caution are factors that cannot be built into this product and must be considered by the operator.**

# TrailerFlex™ Wall Kit

## USERS GUIDE



**NOTE:** The Trailerflex Wall System Kit is designed to “box in” your trailer to create an exterior wall that secures your load in.

### >> PARTS CONTAINED IN THIS TRAILERFLEX WALL SYSTEM / (what’s in the box)

Contents of this TrailerFlex Wall Kit:

- 2 Front Trailer Wall Brackets
- 2 Rear Trailer Wall Brackets
- 4 Security Star Knobs
- 6 Red Cap Plugs
- 2 Backup Marker Indicator Poles
- 1 TrailerFlex Logo Gear Bag

**NOTE:** Lumber and additional screws or fasteners are not provided unless noted in kit contents



Read carefully and understand this material before installing and using this product. Failure to do so and follow all safety recommendations can result in serious injury to users and others. **SAVE THIS GUIDE.**



**DO NOT EXCEED THE LISTED WEIGHT RATING OF YOUR UTILITY TRAILER REGARDLESS OF THE HEIGHT OF YOUR SIDEBOARDS. FOLLOW YOUR TRAILER MANUFACTURER’S GUIDELINES FOR LOAD AND DISTRIBUTION SPECIFICATIONS.**

### >> BRACKET INSTALLATION / ORIENTATION

#### STEP 1:

Identify each TrailerFlex Wall System trailer bracket by the label placed inside of the U-Channel designating the trailer location and match with the below diagram.

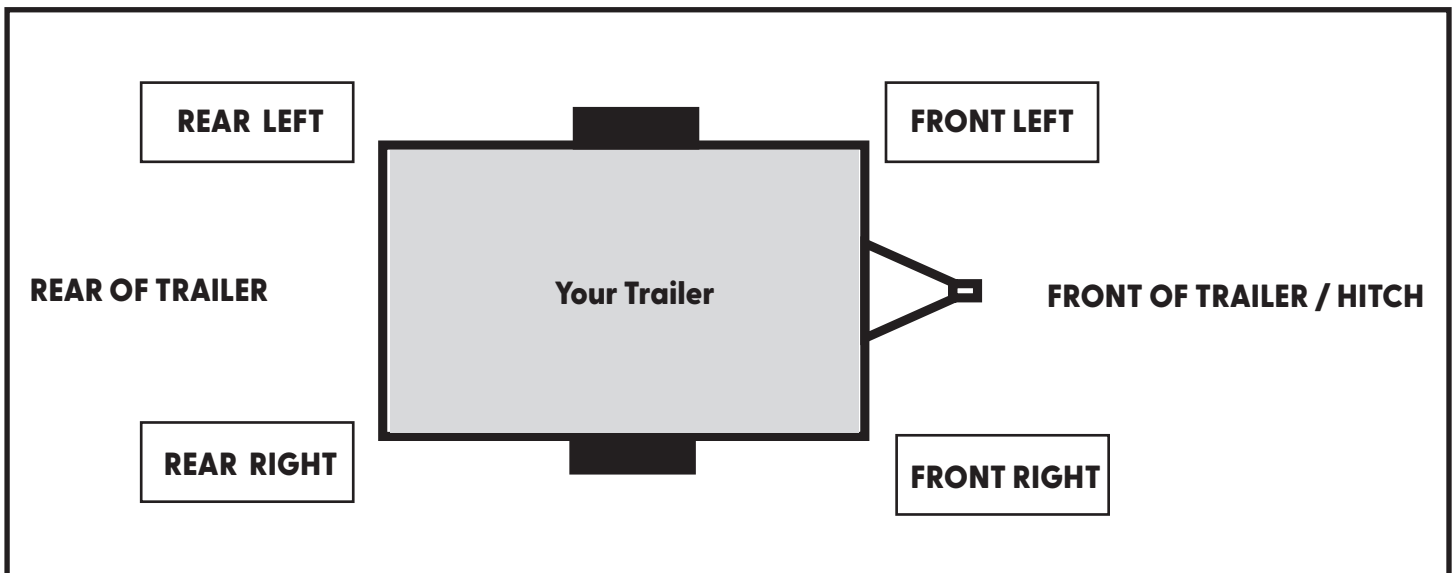

**STEP 2:**

Place each bracket in its proper location on your angle or square tubing trailer rail.

**NOTE: Front brackets must go in each front corner. Rear Brackets can go in any location along the side rails of your trailer that contain an upright support post. Choose the location based on the size of the outer box side wall you want.**

**STEP 3:**

Install the Front Left and Right Brackets onto the rail in the corresponding corner and seat firmly.



**Note: Brackets labeled as FRONT RIGHT and FRONT LEFT can ONLY go on those specific corners of your trailer.**

**STEP 4:**

Install the supplied Security Star knob into the proper weld nut location. The upper weld nut is for angle iron rail trailers and the lower weld nut is for square tube trailer rails.

**UPPER WELD NUT is for ANGLE IRON trailer INSTALLATIONS**

**LOWER WELD NUT is for SQUARE TUBE trailer INSTALLATIONS**

**UPPER WELD NUT** →

**LOWER WELD NUT** →

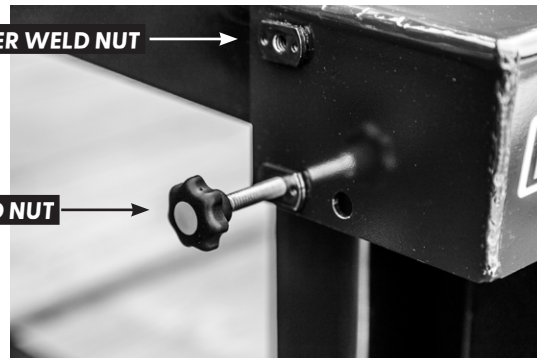

This image shows the star-nut setup for square tube trailer.

**NOTE: TrailerFlex attempts to build Wall System brackets to accommodate all trailers but due to manufacturers varying designs and materials, minor modifications may need to be done. In some cases, if your trailer is built with wider uprights in any location, it may be necessary to drill a hole to allow the Security Star Knob Threads to clear and fully seat the Star Knob. In addition, some trailers may have tiedown brackets welded where interference is an issue. You can remove and relocate these at your discretion if needed.**

## STEP 5:

Fully install the Security Star Knob until it is seated. Do not over-tighten. First installation will have resistance due to the e-coating but will go in with ease after that.

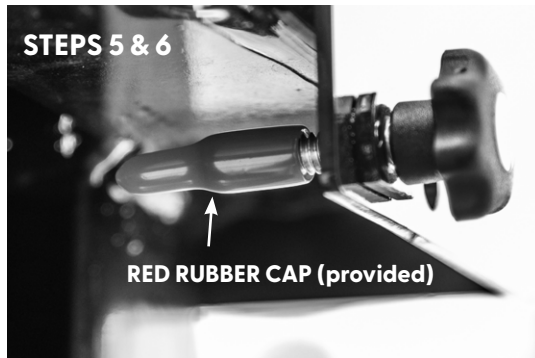

**USER MUST SECURE ALL ATTACHMENT BRACKETS USING THE PROVIDED “SECURITY STAR KNOBS”. THE USE MUST FULLY HAND-TIGHTEN THE “STAR KNOB” AND INSTALL THE RED RUBBER CAP (SUPPLIED) TO KEEP THE STAR KNOB IN PLACE. DO NOT OVER TIGHTEN AND DAMAGE THE KNOB OR THREADS. FAILURE TO INSTALL SECURITY STAR KNOBS COULD RESULT IN SERIOUS BODILY INJURY TO THE USER OR OTHERS.**

## STEP 6:

Install the red Cap Plug onto the fully seated bolt threads. This will help ensure the screw will not vibrate out of the weld nut while in use. (see image above)

## STEP 7:

Install the Rear left and right brackets at any upright post location or at the very rear of the trailer. Ensure the welded “Anti-Kick Back” tab is properly pushed up against the front side of the trailers upright post.

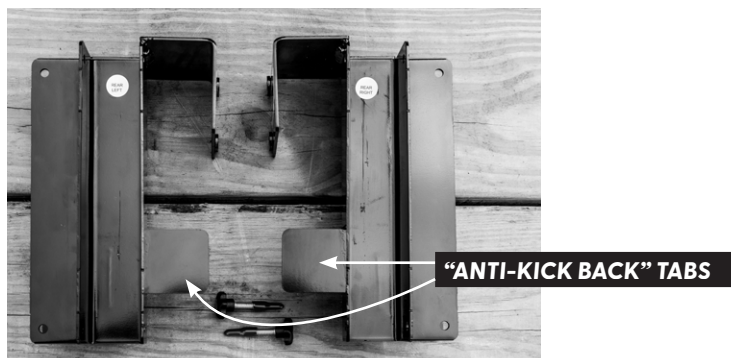

**NOTE: TrailerFlex attempts to build Wall System brackets to accommodate all trailers but due to manufacturers varying designs and materials, minor modifications may need to be done. In some cases, if your trailer is built with wider uprights in any location, it may be necessary to drill a hole to allow the Security Star Knob Threads to clear and fully seat the Star Knob. In addition, some trailers may have tie-down brackets welded where interference is an issue. You can remove and relocate these at your discretion if needed.**

## STEP 8:

As with the front brackets, install the Security Star Knob in its proper weld nut location. (upper for angle trailer rails and lower for square tube rails).

## STEP 9:

Repeat step 5 being careful not to over-tighten.

## STEP 10:

Repeat step 6 and install the red cap plug firmly onto the bolt threads.

## >> BUILDING THE “WALL” / (first time installation)



**ONLY USE SIDEWALL BOARDS AND PANELS THAT ARE IN GOOD SHAPE, SOLID CONDITION WITH NO ROT OR DEFECTS. ALL BOARDS MUST BE CAPTURED IN THE RIGHT CHANNEL. THE CHOICE OF MATERIALS USED IS AT THE DISCRETION OF THE USER. THIS IS THE SOLE RESPONSIBILITY OF THE USER AND TRAILERFLEX ASSUMES NO LIABILITY RELATING TO LOSS OR INJURY RESULTING FROM THE USER-PROVIDED MATERIALS. FAILURE TO DO SO COULD RESULT IN SERIOUS BODILY INJURY TO OTHER USERS OR OTHERS. DO NOT USE BOARDS SMALLER THAN 2” X 6” WITH THE EXCEPTION OF THE “HIGH SIDEWALL KIT” WHERE PLYWOOD OR OTHER PANELS MAY BE USED. ALL LUMBER/BOARDS USED MUST BE CAPTURED WITHIN THE UPRIGHT CHANNELS OF THE FOUR CORNER BRACKETS AND THE “MID-DIVIDER” BRACKETS. ALL FOUR (4) OUTER PERIMETER BOARDS MUST BE IN PLACE TO CREATE A SOLID STRUCTURE.**

### RECOMMENDED!

**TRAILERFLEX RECOMMENDS SECURING ALL SIDEWALL BOARDS TO TRAILERFLEX BRACKETS IN SPECIFIED LOCATIONS USING ONLY STURDY, HIGH-QUALITY FASTENERS OR CAM-LOCK PINS (not provided), THAT PENETRATE THROUGH BOTH SIDES OF THE UPRIGHT CHANNELS AND THE BOARDS. THIS IS AT THE DISCRETION OF THE USER. THIS WILL FURTHER SECURE THE STRUCTURE AND KEEP DEBRIS FROM EXITING THE UNDERSIDE OF THE BOARDS FROM SEVERE BOUNCING WHEN DRIVING ON ROUGH SURFACES.**

**NOTE: Cut 2” x lumber of your choice (2”x 6” or larger can be used). We like 2” x 12” for maximum boxing height but you can also stack any 2”x lumber you have available to achieve your desired height. All lumber must be captured fully within the U-Channel. (Lumber not included)**

**NOTE: If using “green” lumber, allow room for shrinkage of the lumber over time.**

### STEP 1 / WALL BUILD:

Measure from the inside of the installed Front Left U-Channel to the inside of the Front Right Installed U-Channel. For dry lumber subtract approximately 1/4” - 3/8” from your length. For Green Lumber cut to size or subtract up to 1/4” from your length (you can adjust accordingly to ease the fit if needed). Cut your desired 2” x lumber to this length.



### RECOMMENDED!

**FOR MAXIMUM BOXING HEIGHT AND STRENGTH, WE RECOMMEND 2”X12” LUMBER.**



**STEP 2 / WALL BUILD:**

Repeat this process for the Rear Left to Rear Right Bracket

**NOTE: Ensure the welded “Anti-Kick Back” tab is properly pushed up against the front side of the trailer’s upright post.**

**STEP 3 / WALL BUILD:**

Measure from the inside of the installed Front Left U-Channel to the inside of the Rear Left Installed U-Channel. For dry lumber subtract approximately 1/4” - 3/8” from your length. For Green Lumber cut to size or subtract up to 1/4” from your length (you can adjust accordingly to ease the fit if needed). Cut your desired 2” x lumber to this length.



**NOTE: Ensure the welded “Anti-Kick Back” tab is properly pushed up against the front side of the trailer’s upright post to guarantee proper length. (See image in Step 7)**

**STEP 4 / WALL BUILD:**

Repeat this process for the Front Right to Rear Right Bracket

**STEP 5 / WALL BUILD:**

Place each cut 2” x board into its proper location.



## STEP 6 / WALL BUILD:

TrailerFlex recommends for extra safety and rigidity, installing decking screws or other sturdy fasteners of your choice in the two holes (upper/lower) on each 2 x, penetrating at least 1 1/2" of the lumber. If desired the lumber can also be bolted to brackets. Pre-drill the boards by installing them into the U-Channel, marking the lumber on each side at the hole location and drilling using a drill bit slightly larger than the U-Channel holes. Install bolts, washers and nuts of your choice.



**INSPECT ALL BRACKETS AND HARDWARE BEFORE AND AFTER EVERY USE TO ENSURE THERE IS NO DAMAGE OR DEFECT. REPLACE ANY DAMAGED OR SUSPECT COMPONENTS, INCLUDING USER-PROVIDED FASTENERS. FAILURE TO DO SO COULD RESULT IN SERIOUS BODILY INJURY TO THE USER OR OTHER.**

## >> UNINSTALL THE “WALL” SYSTEM

### STEP 1 / UNINSTALL

Reverse the Installation Process for all lumber and brackets.

### STEP 2 / UNINSTALL

Place your TrailerFlex Brackets back into their provided “Gear Bag.”

## >> MAINTENANCE /

Lubricate Security Star Knob threads and the weld nut threads on occasion to prevent rusting.

## >> BACKUP INDICATOR POLES / Installation

### STEP 1 / Backup Indicator poles

Connect the three-piece pole set by installing each bungee corded section into the ferrule of the next section.

### STEP 2 / Backup Indicator poles

Install the Backup Indicator Pole into the Left and Right Rear Bracket top plate holes and lower until fully seated into the Receiver tube. Remove when Backup requirements are completed and store in the Trailerflex Gear Bag for future use.



**PREVENT THEFT** of your Trailerflex Wall Bracket system! By utilizing the locking hole located on the side of each bracket formed plate. Use any standard lock and cable system or packaged 1-piece cable lock of the required length. (not provided in Kit).

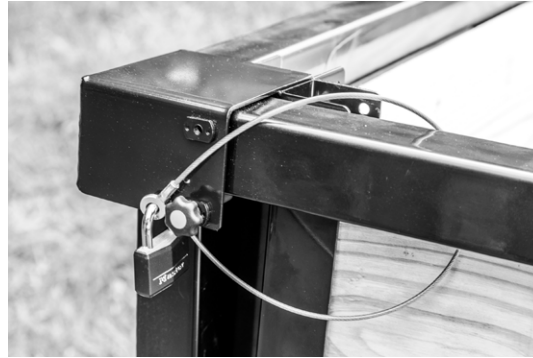

Simply wrap the cable around your trailer rail and lock both cable end loops to the bracket by running your lock through the bracket lock hole and attaching the cables. You can also pass your standard 1-piece cable lock around your trailer rail, through the bracket hole and reconnect to the lock. One will be required for each corner bracket.

**Visit [trailerflex.com](http://trailerflex.com) for additional tips, photos, instructions, videos and additional accessories!**



**STAY SAFE! SECURE ALL LOADS PROPERLY. THIS IS THE USER'S RESPONSIBILITY. FAILURE TO FOLLOW THIS PROCEDURE COULD RESULT IN SERIOUS BODILY INJURY TO THE USERS OR OTHERS.**



**ENSURE THE TRAILER IS EITHER ATTACHED TO THE VEHICLE OR TRAILER WHEELS ARE CHOCKED BEFORE ATTEMPTING TO INSTALL THE BRACKETS OR LOAD ANY OBJECTS ONTO THE TRAILER.**



**DO NOT CUT, DRILL OR MODIFY THIS PRODUCT IN ANY WAY, NOT SPELLED OUT IN THIS USERS GUIDE. FAILURE TO COMPLY WILL VOID ANY AND ALL WARRANTIES AND COULD CAUSE SERIOUS INJURY TO USER AND OTHERS.**

### >> **ADDITIONAL INSTALLATION PRECAUTIONS**

1. Install **ONLY** according to these Instructions. Improper installation can create hazards.
2. Wear ANSI-approved safety goggles and heavy-duty work gloves during installation if power tools are being used.
3. Keep the installation area clean and well-lit.
4. Keep bystanders out of the area during installation.
5. Do not install when tired or when under the use of alcohol, drugs, or medication.
6. Verify that there are no obstructions to the trailer's marker, running or taillights, or license plate and ensure there are no protruding loaded materials that could impact other objects outside of the trailer's sidewalls and railing.



## >> ADDITIONAL USE PRECAUTIONS

1. This product is not a toy. Do not allow children to play with or near this item.
2. Use as intended only.
3. Comply with all local, state, and federal regulations regarding installation and use.
4. Be aware of “dynamic loading!” Any sudden load movement may cause product failure and unsafe conditions.
5. Retain all product manuals. These contain important safety information. If replacements are needed contact Trailerflex at [info@trailerflex.com](mailto:info@trailerflex.com)



**READ THE ENTIRE IMPORTANT SAFETY INFORMATION SECTION AT THE BEGINNING OF THIS DOCUMENT INCLUDING ALL TEXT UNDER THE SUBHEADS THEREIN BEFORE INSTALLATION OR USE OF THIS PRODUCT.**



**WARNING!**

**DO NOT ATTEMPT TO INSTALL THIS PRODUCT IF YOU ARE NOT COMFORTABLE AND SKILLED AT DOING THIS TYPE OF WORK. THIS IS A CUSTOM INSTALLED PRODUCT THAT REQUIRE PRECISE MEASUREMENTS, LUMBER CUTTING AND /OR POTENTIALLY DRILLING THAT IS UNIQUE TO EACH TRAILERS DESIGN AND SIZE.**

**Visit [trailerflex.com](https://trailerflex.com) for additional tips, photos, instructions, videos and additional accessories!**

## NOTES:

